

\$ - B4-b6 - 20 Meadowglen Place, Toronto (woburn)

MLS® #E8114714

\$

0 Bedroom, 0.00 Bathroom, 2,337 sqft
Retail

Woburn, Toronto (woburn), Ontario

This New Mixed-Use Community With Prime Retail Space On The Main Floor Is Strategically Located In Close Proximity To Highway #401. Minutes Away From Shopping Centers, Financial And Educational Institution. T.M.I Is An Estimate ****EXTRAS**** Can be demised to U#B4 - 773 SF / U#B5 - 801 SF / U#B6 - 761 SF / U#B4-B5 = 1,574 SF / U#B5-B6 = 1,563 SF (Based on rentable area). (id:6289)

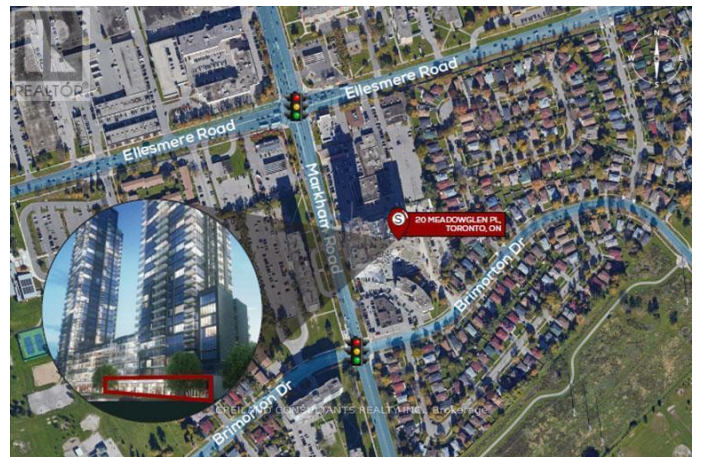

Essential Information

Listing #	E8114714
Bathrooms	0.00
Square Footage	2,337
Type	Retail

Community Information

Address	B4-b6 - 20 Meadowglen Place
Subdivision	Woburn
City	Toronto (woburn)
Province	Ontario
Postal Code	M1H2Y5

Amenities

Parking	Underground
---------	-------------

Interior

Heating	Natural gas Other
Cooling	Fully air conditioned

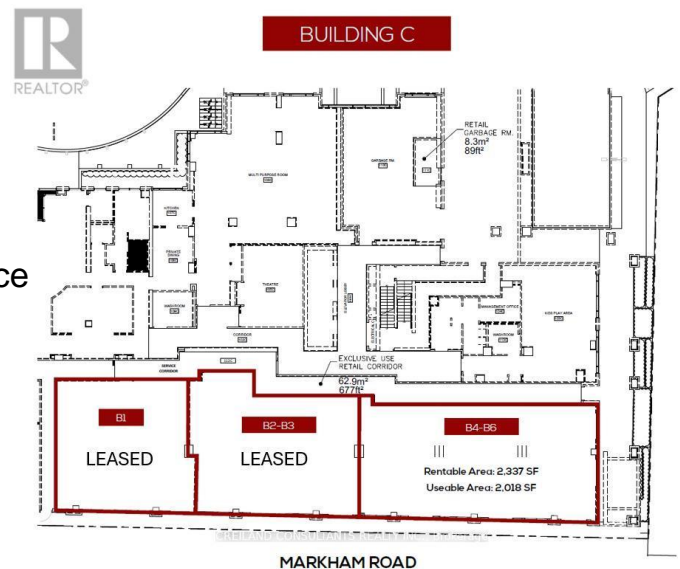

Listing Details

Listing Office CREILAND CONSULTANTS REALTY INC.

MLS®, REALTOR®, and the associated logos are trademarks of The Canadian Real Estate Association.